

3 Windows Display Based On 8Kx1K Split
Flexible 4 Port Split with 4 Layers Configuration

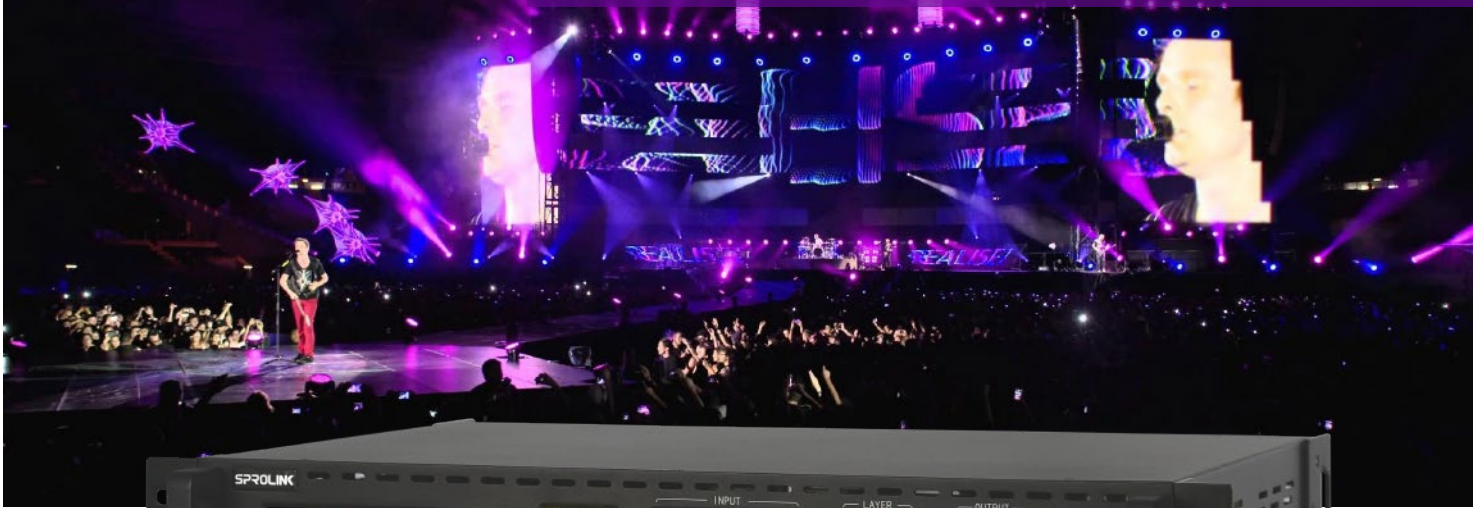

MODEL **VS2**

- Support 4 Port Split in Any Configuration
- Seamless Switching Between Any Signals
- Smooth Fade in Fade out Transition
- Support 4Kx2K 8Kx1K 2Kx4K Pixel to Pixel Split
- Flexible Quad Layers display
- Support 4 Optional Module
- Open API
- RCA Audio Output Jack
- Optional Genlock Input for Cascade Split

SPROLINK[®]

www.sprolink.com

PRODUCT FEATURES

Optional Module Slot

VS2 Supports any 4 optional modules, Including Genlock, SDI, HDMI1.4, DVI, VGA/YPbPr, USB

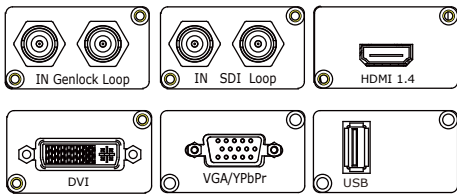

Input Preview

The HDMI Port can preview all the input channel or simply used as flexible signal loop port.

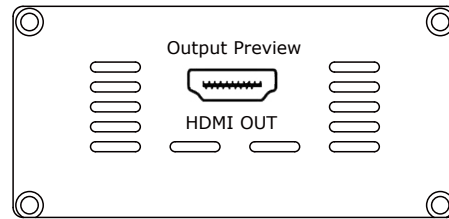

Multiple Windows Display

VS2 Supports max 4 layers display, can overlay anywhere in any position.



Fade in Fade Out Seamless Switching

VS2 Supports fade-in and fade-out seamless switching and cut switching between any of the 4 layers. It makes the switching more softly and smoothly by 256 level ALPHA.



3D Display

VS2 supports left-right 3D split, and can realize one button switching between 2D and 3D display via Software.



Crop & Zoom by Layers

VS2 support Layer crop & zoom. Ideal for creative screen mapping.

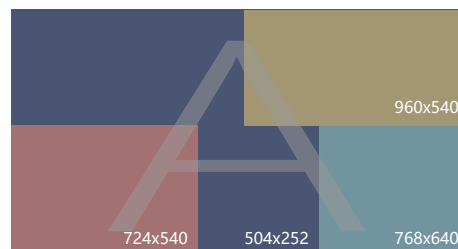

Ultra Wide Range Split

Single port supports widest 3840, and highest 3840 within 2.5Million customized resolution.

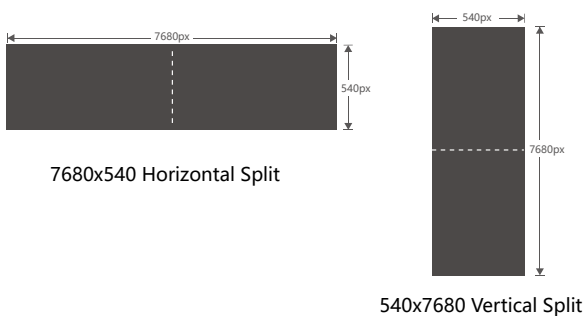

Windows Rotation

Each layer supports 90,180, 270 degree, mirror rotation to realize personalized display.



PRODUCT APPLICATIONS

Application 1: 3 Windows Display Based on 4K x 1K Split

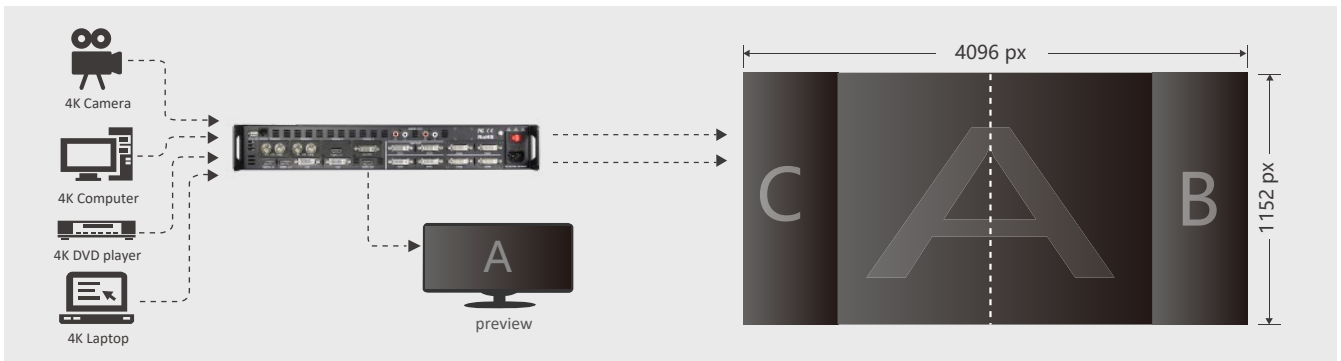

Application 2: Multiple-Window Preview Seamless Switching on Single Port

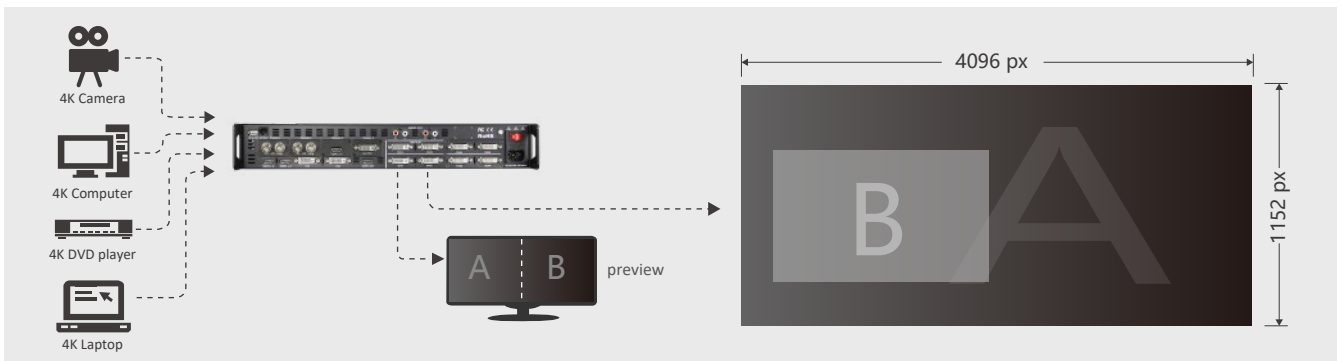

Application 3: 3 Windows Display Based on 8K x 1K Split

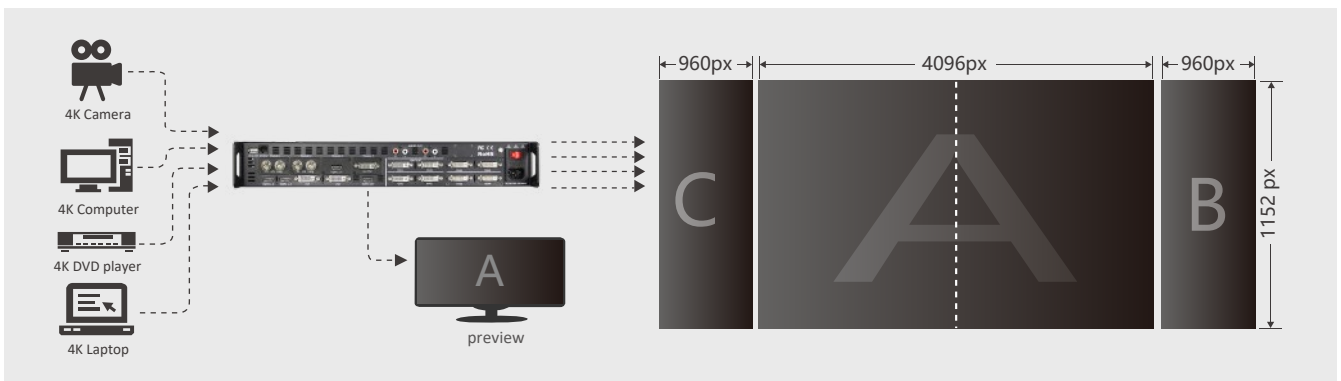

Application 4: Cascade For 8K x 2K Split

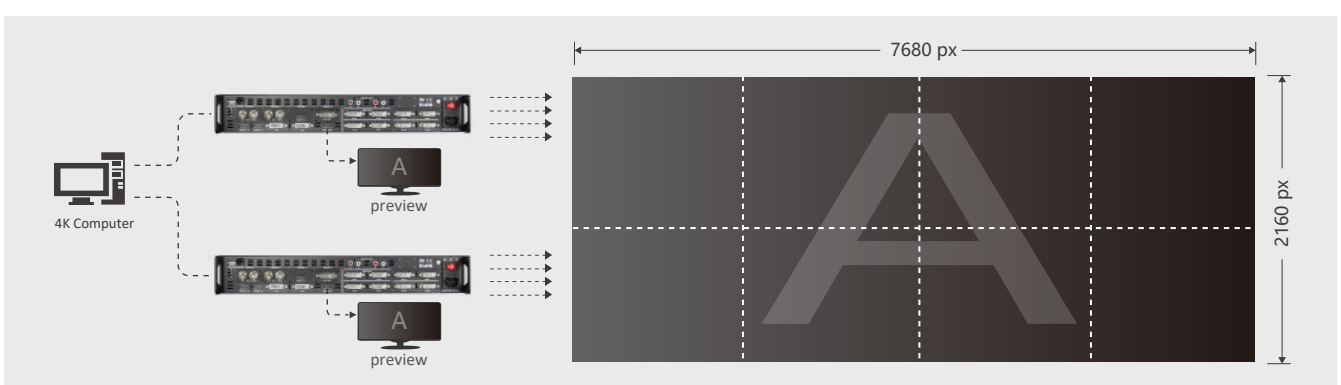



SPECIFICATION

Input Interface	Standard	1 × HDMI 1.4 1 × HDMI 1.3 2 × DVI
	Optional	4 × HDMI 1.4 4 × DVI 4 × 3G-SDI+SDI LOOP 4 × VGA 4 × USB 1 × Genlock IN+Genlock Loop
Output Interface	Standard	4 × DVI(Output) + 4 × DVI(Backup) ; 1xHDMI (Preview) ; 4x RCA(2xLR Stereo Audio Jack)
Operation		Button, RS232, Control Software
Input Resolution	DVI	HDMI1.3
	HDMI	SMPTE: 480i 576i 720p 1080i 1080p VESA: 1024x768 1280x720 1600x1200 1920x1080 1920x1200 2048x1152 3840x1080
	VGA	VESA: 1024x768 1280x1024 1600x1200 1920x1080 1920x1200 2048x1152
	SDI	480i 576i 720p 1080i 1080p 1080 psf
	USB	JPEG, BMP, PNG, MP4, MPEG1, MPEG2, RMVB, MJPG, MP4, AVI
Output Resolution	VESA	1024x768 1280x720 1280x1024 1400x1050 1600x1200 1920x1080 1920x1200 2048x1152 2560x816 1024x1280 1152x1152 1280x1280 1536x1536 2560x1024 2560x1600 3840x540 Customized point to point display
Support Protocol	DVI	1.0
	HDMI	1.3 / 1.4
	VGA	VGA-U
	SDI	SD-SDI / HD-SDI / 3G-SDI
	Refresh Rate	23.98/24/25/29.97/30/50/59.94/60Hz
Input voltage		AC 100~264V (Typical value110/220) 50/60Hz
Max power		45W
TEMP		-25°C~55°C (Typical value25°C)
Humidity		20%~90%
Weight		5.0kg (Equipment Weight)
		6.5kg (Transport Weight)
Size		480mm x 395mm x 67mm (Equipment Size)
		540mm x 455mm x 140mm (Transport Size)

PRODUCT CODE

Product Code	Item	Product Code	Item
P180-VS2-000-01	VS2	P180-VS2-000-05	VGA Input
P180-VS2-000-02	SDI Input	P180-VS2-000-06	USB Input
P180-VS2-000-03	DVI Input	P180-VS2-000-07	Genlock Input
P180-VS2-000-04	HDMI 1.4 Input	P180-VS2-000-08	HDMI Preview Output

